

**INSTRUCTIVE!**

# BEAM CLAMO WITH SHACKLE TYPE



## SAFE USE

- Ensure that the beam clamp is of the correct capacity for the elevated load and that it will not be damaged by localized overload.
- Ensure that the clamp is correctly positioned over the center of gravity of the item being lifted.
- Before lifting a load, ensure that the clamp has been secured and that the lifting device has been properly installed in the eye of the clamp.
- During service and maintenance inspection, ensure that the clamps are kept clean and that moving parts are lubricated.
- Regularly inspect beam clamps for wear, damage, distortion, cracks, and defects that may pose a hazard.
- If any of the above defects are found, remove the beam clamp from service and transfer it to a competent person.

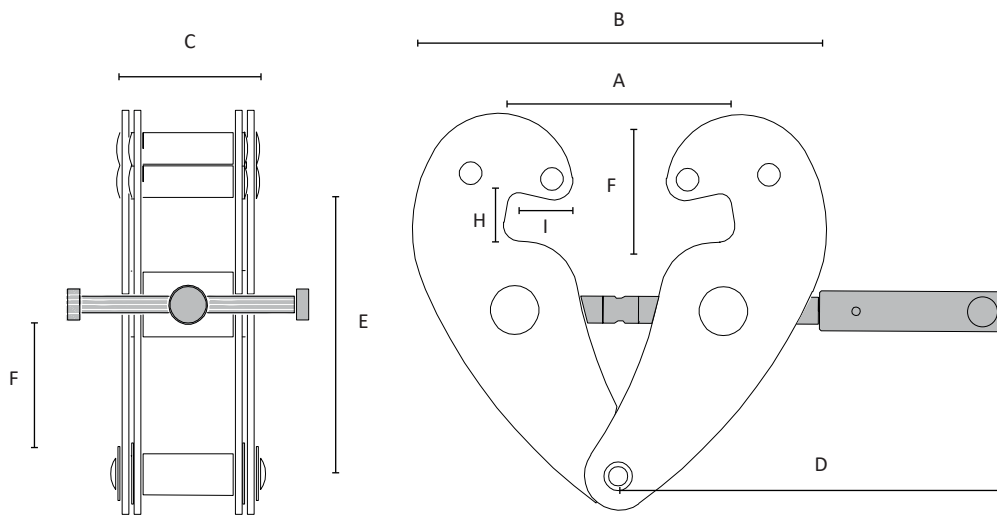

## SPECIFICATIONS

**Meets or exceeds standards ASME B30.20 - EN 13155.**

WLL t.	Opening mm	Dimensions* mm							Weight* kg
		A max.	B min-max.	C	E min-max.	F min.	H	I	
1	75 - 230	260	360 - 180	64	105 - 102	25	24	20	3,8
2	75 - 230	290	400 - 185	85	165 - 90	25	25	20	4,8
3	80 - 320	354	490 - 235	103	225 - 140	45	40	25	9,2
5	90 - 310	354	490 - 235	110	225 - 140	45	40	25	11
10	90 - 320	365	505 - 320	120	235 - 170	50	42	25	15,5

\*Approximate dimensions and weights | Gorila Brand | Certified Product

