



INSTRUCTIVE /
PLATE CLAMP WITH
SAFETY LOCK



SECURITY

- Clamps used for different applications must be stored separately and in places free from moisture.
- If necessary, identify each clamp with a distinctive color indicating its load capacity.
- Check each clamp once a week to ensure proper functioning in the following terms:
 - a. Normal operating condition.
 - b. Grinding wheel wear.
 - c. Opening without difficulty.
- If equipment damage is detected, such as fractures or wear in welded sections, immediately cease use until the extent of damage is verified.
- If discarding a clamp, clearly identify it and remove it from the operating site.
- Record clamp inspections.

INSPECTION AND MAINTENANCE

- Ensure the load's condition when being lifted.
- Use the correct clamp for the application type.
- Ensure clamps operate under optimal conditions in terms of capacity, opening, and closing.
- For lifting a plate, use two vertical clamps. During lifting application, keep clear of the items being lifted. Follow clamp operation procedures.

INSTRUCTIONS FOR USE

- Improper use can cause serious personal injury and property damage. Use the product appropriately and for its intended purpose.
- Visually inspect before each use; if deformations are observed in the body, suspension arm, or wear on its wheels, do not use it.
- Verify the weight and dimensions of the load before lifting. Consider that angles increase efforts.
- Properly balance the load. When the load has dimensions that are difficult to control, use a maneuver with two clamps to prevent swinging.
- Ensure the selected clamp corresponds to the minimum and maximum recommended opening conditions by the manufacturer.
- Insert the clamp jaw until it contacts the edge of the load (never lift with the clamp partially engaged), then close the safety latch.
- Note that there are special steels with high surface hardness, which are not recommended for safe lifting with this model. In these cases, contact the manufacturer or distributor; they will advise on the most suitable product for each application.

INSTRUCTIVE | PLATE CLAMP WITH SAFETY LOCK

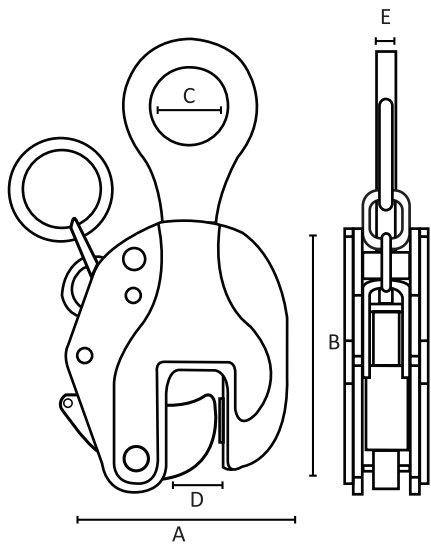

Complies with or exceeds standards ASME B30.20 | EN 13155

WLL t.	Apertura mm	Dimensiones* mm					Peso* kg
		A	B	C	E	F	
1	22	124	158	50	30	14	3,6
2	30	154	190	54	40	16	5,5
3,2	40	180	230	60	50	18	10
5	50	222	283	68	62	18	17
10	90	290	365	80	90	25	32

*Approximate dimensions and weights | Gorila Brand | Certified Product

PARTS AND PIECES

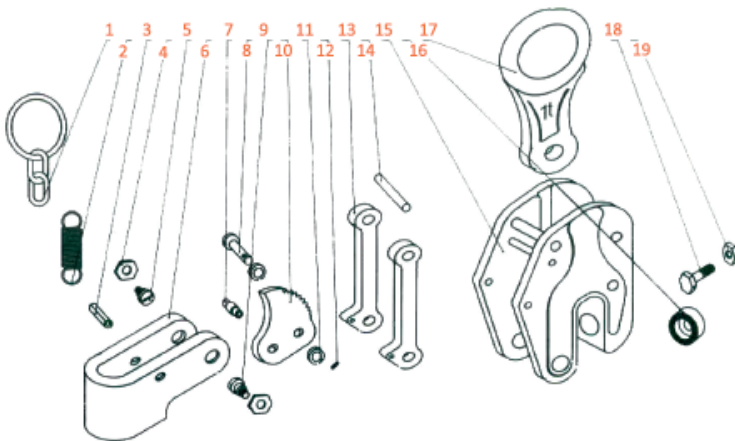

1. Ring.
2. Spring.
3. Spring pin.
4. Nut.
5. Bolt.
6. Link pin.
7. Grinding wheel shaft.
8. Bolt.
9. Grinding wheel.
10. Separator.
11. Elastic pin.
12. Joint.
13. Joint shaft.
14. Clamp body.
15. Fixed grinding wheel.
16. Lifting arm.
17. Bolt.
18. Nut.

USES OF HORIZONTAL CLAMP

